

# EXPLOSIONSZEICHNUNG



KBS Gastrotechnik GmbH – Schoßbergstraße 26 – 65201 Wiesbaden



**pastorkalt a.s.**

# KUBUS V SS

NAHRADNE DIELY  
SPARE PARTS

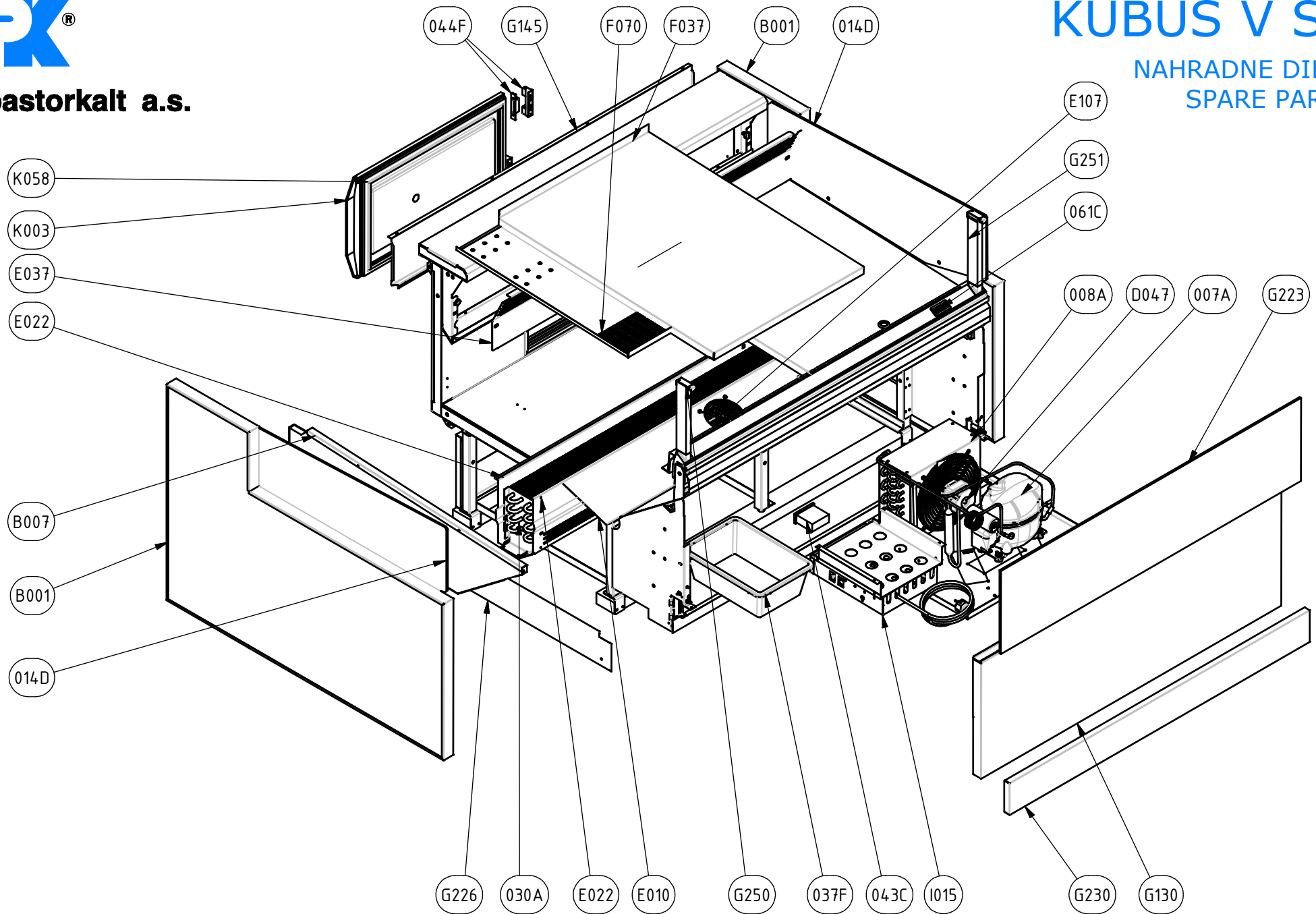

Pastorkalt a.s. reserves the right to change.

<b>Kód dielca</b>	<b>Názov dielca</b>	<b>Názov dielca skratka</b>
001A	Akumulator kvapaliny	
002A	Bok kondenzatora	Bok KND
003A	Bok vyparnika	Bok VYP
004A		
005A	Filterdahydrator	FILDEH
006A	Koleno	
007A	Kompresor	
008A	Kondenzator	
009A	Akumulator chladiva	
010A	Elektronika kompresora	
011A	Kryt kondenzatora	Kryt KND
012A	Kryt ventilatora	
013A	Lamela kondenzatora	Lamela KND
014A	Lamela vyparnika	Lamela VYP
015A	Cievka ventila	
016A	Mriezka ventilatora	
017A	Priruba ventilatora	
018A	Rozdelovac	
019A	Rurka kondenzatora	Rurka KND
020A	Rurka vyparnika	Rurka VYP
021A	Solenoid	
022A	Spirala odparovania	
023A	Spojka T	
024A	Ventil	
025A	Ventil expanzny	Ventil EXP
026A	Ventil gulovy	
027A	Ventil plniaci	
028A	Ventilator	
029A	Vrtula	
030A	Vyparnik	VYP
031A	Adapter k expanznemu ventilu	Adapter exp ventil
032A	Tryska k expanznemu ventilu	Tryska exp ventil
033A	Motor	
034A	Sonda	
001B	Lepidlo	
001C	Doraz	
002C	Display	
003C	Halogen	
004C	Istic	
005C	Kabel privodny	
006C	Kabel vyhrevny	
007C	Kable	
008C	Klips	
009C	Cidlo	
010C	Kolecko termostatu	

011C	Kondenzator odrusovaci	Kond odrus
012C	Konektor	
013C	Komunikacny modul	Kom modul
014C	Koniec krytu ziarivky	
015C	Kontrolka	
016C	Krabica elektricka	Krabica el
017C		
018C	Kryt LED	
019C	Kryt ziarivky	
020C	Kryt ziarivky, T5	
021C	Lista DIN	
022C	Objimka	
023C	Objimka ziarivky	
024C	Objimka halogena	
025C	Objimka so starterom	
026C	Objimka startera	Objimka start
027C	Mostik	
028C	Ocko zemniace	
029C	Ovladanie	
030C		
031C		
032C	Patica	
033C	Pasik LED	
034C	Predradnik	
035C		
036C		
037C		
038C	Prechodka	
039C	Prepinac	
040C	Prichytka	
041C		
042C	Profil LED	
043C	Regulator	
044C	Rele	
045C		
046C		
047C	Spinac	
048C	Spinac hladinovy	
049C	Spinac plavakovy	
050C	Starter	
051C	Stykac	
052C	Svietidlo	
053C		
054C		
055C	Svorka radova	
056C	Svorkovnica	
057C		
058C		
059C	Teleso vyhrevne	

060C	Teplomer mechanicky	Teplomer mech
061C	Teplomer solarny	
062C	Termostat blokacny	
063C	Termostat regulacny	
064C	Tlmivka	
065C	Tyc vyhrevna do misky	
066C	Tyc vyhrevna	
067C	Ventil expanzny	
068C	Vypinac	
069C	Vypinac hlavny	
070C	Zaslepka LED	
071C	Zastrcka	
072C		
073C		
074C	Zasuvka	
075C	Ziaric infra	
076C	Ziarivka	
077C		
078C		
079C		
080C		
081C		
082C	Tlacidko	
083C		
084C		
085C		
086C		
087C	Objimky s konektorom	
088C	Spinac magneticky	
089C		
090C	Cerpadlo	
091C	Filter UV	
092C	Ultrazvukove zvlhcovanie	
001D	Dvere	
002D	Dvojsklo bocnice	
003D	Dvojsklo celne	
004D	Dvojsklo horne	
005D	Kryt sklenený	
006D	Kryt sklenený duo	
007D	Kryt sklenený solo	
008D	Lista dvojskla	
009D	Panel	
010D	Polica sklenená	
011D	Prepazka	
012D	Ramik	
013D	Sietotlac	
014D	Sklo bocne	
015D	Sklo celne	
016D	Sklo celne duo	

017D	Sklo celne kraj	
018D	Sklo celne solo	
019D	Sklo celne stred	
020D	Trojsklo bocnice	
021D	Trojsklo celne	
022D	Usmernovac vzduchu	
023D	Zarazka celna	
024D	Zrkadlo	
025D	Zrkadlo bocnice	
026D	Sklo dvojskla	
027D	Sklo zadne	
028D	Sklo	
029D	Dvojsklo	
030D	Kryt	
031D	Spojka skla	
001F	Cap pantu dvier	
002F	Distancny kruzok	
003F	Drziak hadice kondenzatora	Drziak hadice kond
004F	Drziak madla	
005F	Drziak naraznika	
006F	Drziak rolety	
007F	Gastronadoba	
008F	Bednicka	
009F	Doraz skla	
010F	Drziak	
011F	Adapter	
012F		
013F		
014F	Gombik	
015F	Guma prechodka	
016F	Hmozdenka	
017F	Cerpadlo	
018F	Kanalizacia	
019F	Koleno	
020F		
021F	Koliesko	
022F	Koliesko s brzdou	
023F		
024F	Koliesko pravitka	
025F	Lozisko	
026F	Kovanie posuvne	
027F	Koniec naraznikovej listy	
028F	Kosik	
029F	Kryt vypinaca	
030F	Kryt zavitovej tyce	
031F	Krytka rohova	
032F	Magnet sokla	
033F	Matica nosica hladin spinaca	
034F	Matica prechodky	

035F		
036F		
037F	Miska kondenzu	
038F		
039F		
040F		
041F	Nosic hladinoveho spinaca	Nosic hladin spinaca
042F	Nosic trubky	
043F	Noha nastavovacia	Noha nast
044F	Pant dvier	
045F		
046F	Paska stahovacia	
047F	Patka samolepiaca	
048F	Patka trubky	
049F	Podstavec vnutornej stojiny	
050F	Pravitko	
051F	Platna	
052F		
053F		
054F	Prechodka	
055F		
056F		
057F	Presostat	
058F		
059F	Prichytka skla	
060F	Priruba hadice	
061F	Priruba kanalizacie	Priruba kanal
062F	Puzdro pantu	
063F	Regulator kondenzacneho tlaku	Regulator kond tlaku
064F		
065F	Redukcia	
066F		
067F	Pruzina	
068F	Roh	
069F	Roh naraznikovej listy	Roh naraz listy
070F	Roleta	
071F	Rukovat	
072F	Roleta clankova	Roleta TSI
073F		
074F		
075F		
076F	Rurka	
077F		
078F		
079F	Rurka distancna	
080F		
081F		
082F		
083F		
084F		

085F	Sifon	
086F	Spojka	
087F		
088F	Spojka kanalizacie	Spojka kanal
089F	Spojka trubiek	
090F		
091F	Teplomer plexisklovy	
092F	Tlmic	
093F		
094F		
095F		
096F		
097F		
098F	Tlmic skla	
099F		
100F		
101F		
102F	Trubka	
103F		
104F	Tyc zavitova	
105F	Ventil	
106F	Zatka	
107F		
108F		
109F		
110F		
111F	Krytka prichytky zrkadla	
112F		
113F		
114F	Skrutka	
115F		
116F	Matica	
117F		
118F		
119F	Hadica pancierova	
120F	Hadica vysokotlaka	Hadica vystlak
121F	Koleno so zavitom	
122F	Vlozka redukcna	
123F	Rivet	
124F	Vsuvka sesthranna redukovana	
125F		
126F		
127F	Doraz police	
128F	Matica expanzneho ventil	Matica exp ventil
129F	Podlozka	
130F		
131F		



132F	
133F	
134F	Popruh
135F	
136F	
137F	Natrubok redukovaný
138F	Priruba hadicova
139F	Prichytka kabla
140F	Lista cenovkova
141F	
142F	
143F	
144F	
145F	Prisavka
146F	Rychlospojka
147F	
148F	
149F	
150F	
151F	
152F	Zaves rolety
153F	
154F	Zamok
155F	
156F	
157F	
158F	Vozik dolny
159F	Vozik horny
160F	Profil
161F	Spojka rohova
162F	Madlo
163F	
164F	
165F	
166F	
167F	
168F	
169F	
170F	Silentblock
171F	Skrutka stavacia
172F	Trubka vymedzovacia
173F	Krytka hlavy skrutky
174F	Posuv
175F	Cenovka
176F	
177F	
178F	
179F	Puzdro tlmica
180F	Noha
181F	Klip

182F	Koncovka prepadu	
183F	Matica koncovky	
001G	Skrutka	
002G	Matica	
003G	Podlozka	
004G	Zavlacka	
005G	Nit	
006G	Cap	
007G	Poistny kruzok	
008G	Samorezka	
009G	Matica nitovacia	
010G	Vlozka	
011G	Tyc zavitova	
001H	Hranol	
002H	Latka	
003H	Noha palety	
004H	Paleta	
005H	Bocnica obalu	
006H	Celo obalu	
007H	Vrch obalu	
008H	Debna	
001I	Znacka vysky tovaru	
002I	Nalepka vysokozdvizny vozik	
003I	Roh kartonovy	
004I	Ochrana hrany	
005I	Polystyren	
A001	Bok vnutorny	
A002	Bok vonkajsi	
A003		
A004	Doraz vyklopny	
A005		
A006	Drziak misky kondenzu	
A007		
A008		
A009		
A010	Drziak pracovnej dosky	Drziak prac dosky
A011	Drziak vyfukovej mriezky	Drziak mriezky vyfuk
A012	Hadica elektro	
A013	Hranol MDF	
A014	Kryt ziarica infra	
A015	Kryt otvoru	
A016	Kryt vane	
A017		
A018	Kryt vanicky	
A019	Kryt vanicky predny	
A020	Kryt ziarica	

A021	Lamela police	
A022	Celo	
A023	Kryt	
A024	Lista dvier pozdlzna	
A025	Lista dvier priecna	
A026	Lista naraznikova	
A027	Lista dvier zostava	
A028	Lozko vyhrevnej snury	
A029	Nosic plexiskla	Nosic plexi
A030	Nosic police predny	
A031	Nosic police zadny	
A032	Nosic vyfukovej mriezky	Nosic vyfuk mriezky
A033	Ochrana hrany horna	
A034	Ochrana hrany vertikalna	Ochrana hrany ver
A035	Lista	
A036	Podlozka	
A037	Podpera	
A038	Podpera dolna	
A039	Podpera horna	
A040	Podpera police	
A041	Podpera stropu	
A042	Podpera vyfukovej mriezky	Podpera vyfuk mriezky
A043	Podpera zadneho panela	Podpera zad panela
A044	Podpera stojiny	
A045	Polystyren	
A046	Polyuretan	PUR
A047	Predlzenie	
A048		
A049	Prepazka	
A050		
A051	Prepazka vane	
A052	Profil skla	
A053		
A054		
A055	Ram	
A056	Ram drevenejej vystuhy	Ram drev vystuhy
A057	Spojka vystuhy	
A058	Rozpera vystuhy	
A059	Spevnenie vystuhy	
A060	Spodok dreveny	
A061		
A062	Spodok vane	
A063	Spodok vnutorny	Spodok vnut
A064		
A065	Spodok vonkajsi	Spodok vonk
A066		
A067		
A068		
A069	Spojka vane	
A070	Stena predna	

A071		
A072		
A073	Stena vnutorna	Stena vnut
A074		
A075	Stena vonkajsia	Stena vonk
A076		
A077	Stena zadna	
A078	Stena zadna vnutorna	Stena zadna vnut
A079	Stena zadna vonkajsia	Stena zadna vonk
A080	Stlpik zadny	
A081		
A082		
A083	Stred obojstranny	Stred obojstr
A084	Stred vane	
A085	Stred vnutorny	Stred vnut
A086	Stred vonkajsi	Stred vonk
A087		
A088	Uholnik spojovaci	
A089	Upchavka pozdlzna	Upchavka pozdlz
A090		
A091	Vana	
A092		
A093	Vlozka dolna	
A094	Vlozka horna	
A095	Vlozka vane	
A096	Vlozka vnutorna	Vlozka vnut
A097	Vlozka vonkajsia	Vlozka vonk
A098	Vrch vane	
A099	Vrch vnutorny	Vrch vnut
A100	Vrch vonkajsi	Vrch vonk
A101	Vystuha	
A102		
A103		
A104	Vystuha dolna	
A105		
A106		
A107	Vystuha horna	
A108	Vystuha kotviaca	
A109		
A110		
A111		
A112	Vystuha predna	
A113		
A114		
A115	Vystuha stredna	
A116		
A117		
A118	Vystuha vane	
A119		
A120		

A121	Vystuha zadna
A122	
A123	
A124	
A125	
A126	
A127	
A128	
A129	
A130	
A131	
A132	
A133	
A134	
A135	Lapac necistot
A136	
A137	Kryt profilu
A138	Izolaca
A140	Panel prechodky
A141	
A142	
A143	
A144	
A145	
A146	
A147	
A148	
A149	
A150	
A151	
A152	
A153	
A154	
A155	Miska kondenzu
A156	Kryt dreveneje vystuhy
A157	Miska odkvapů
A158	Miska
A159	
A160	Kryt vystuhy
A161	
A162	
A163	Patka strednej vystuhy
A164	
A165	
A166	Nekus sem nieco dopisat !!!
A167	Stojina
A168	Lista
B001	Bocnica

B002		
B003	Bocnica DTD	
B004	Bocnica horna	
B005	Bocnica dolna	
B006		
B007	Bocnica izolacna	
B008	Bocnica MDF	
B009	Bocnica plna	
B010		
B011		
B012	Bocnica presklena	
B013	Bocnica spodok	
B014		
B015	Bocnica zrkadlova	
B016	Divizorio obojstranne	
B017	Dvojsklo bocnice	
B018	Doraz skla bocnice	
B019	Drziak sokla bocnice	
B020	Hadica bocnice elektro	
B021	Kapaline bocnice	
B022	Kryt bocnice	
B023	Kryt bocnice dolny	
B024	Kryt bocnice horny	
B025	Kryt bocnice horny predny	
B026	Kryt bocnice horny zadny	
B027	Kryt bocnice s ohybom	
B028	Kryt bocnice vnutorny	
B029	Kryt bocnice vonkajsi	
B030	Kryt bocnice zadny	
B031	Kryt izolacnej bocnice	
B032	Kryt izolacnej bocnice vnutorny	Kryt bocnice izol vnutorny
B033	Kryt izolacnej bocnice vonkajsi	Kryt bocnice izol vonkajsi
B034	Kryt izolacnej vysokej bocnice	
B035	Kryt lampy bocnice	Kryt lampy
B036	Kryt rozny	
B037	Kryt rohu bocnice vnutorny	Kryt rohu vnut
B038	Kryt rohu bocnice vonkajsi	Kryt rohu vonk
B039		
B040	Lista bocnice celna	Lista boc celna
B041	Lista bocnice	Lista boc
B042	Lista bocnice krycia	Lista boc krycia
B043	Lista dvojskla bocnice	
B044	Lista bocnice naraznikova	Lista boc naraz

B045	Lista bocnice obvodova	Lista boc obv
B046	Lista otvoru	
B047	Lista divizoria krycia	
B048	Lista izolacnej bocnice	Lista izol bocnice
B049	Lista osvetlenia bocnice	
B050	Lista skla bocnice	
B051		
B052		
B053	Lista uchytenia skla bocnice	Lista uchyt skla boc
B054	Obrys bocnice	
B055	Odliatok rohu bocnice	
B056	Ochrana sokla bocnice	Ochrana sokla boc
B057	Ochrana spodku bocnice	
B058	Panel bocnice	
B059	Panel bocnice kryci	
B060	Plech bocnice	
B061		
B062	Plech bocnice vnutorny	Plech boc vnut
B063		
B064	Plech bocnice vonkajsi	Plech boc vonk
B065		
B066		
B067		
B068	Plech zapustenia bocnice	Plech zapustenia
B069		
B070	Podpera sokla bocnice	Podpera sokla
B071	Podpera	
B072	Polyuretan bocnice	PUR bocnice
B073	Prichytka vylisku bocnice	
B074	Profil skla bocnice	
B075	Regal bocnice	
B076	Roh bocnice	
B077		
B078	Sklo bocnice	
B079	Sokel bocnice	
B080	Spodok bocnice	Spodok boc
B081	Spodok bocnice vnutorny	Spodok boc vnut
B082	Spodok bocnice vonkajsi	Spodok boc vonk
B083	Stena bocnice	Stena boc
B084	Stena bocnice vonkajsia	Stena boc vonk
B085	Stena bocnice vnutorna	Stena boc vnut
B086	Stred bocnice	Stred boc
B087	Stred bocnice vonkajsi	Stred boc vonk
B088	Stred bocnice vnutorny	Stred boc vnut
B089	Tienidlo bocnice	
B090	Tyc bocnice	

B091	Uholnik uchytenia bocnice	
B092	Uchyt skla bocnice	
B093	Vedenie bocnice	Vedenie boc
B094	Vedenie naraznikovej listy bocnice	
B095	Vedenie skla bocnice	Vedenie skla
B096	Vlozka bocnice	
B097	Vlozka bocnice vypenovacia	
B098	Vrch bocnice	
B099	Vylisok bocnice	
B100	Vylisok bocnice vnutorny	Vylisok boc vnut
B101	Vylisok bocnice vonkajsi	Vylisok boc vonk
B102	Vypln vylisku bocnice	
B103	Vystuha bocnice	
B104	Vystuha kotviaca	
B105	Vystuha polystyrenova	Vystruha polyst
B106		
B107	Vystuha osvetlenia bocnice	
B108	Vystuha rohu	
B109	Vystuha	
B110	Bocnica Q	
B111		
B112		
B113		
B114	Lista vložky dolna	
B115	Lista vložky horna	
B116	Lista vložky zadna	
B117	Plech vložky bocnice	
B118	Kapaline vložky bocnice	
B119	HPS vložky bocnice	
B120	Izolacia bocnice	
B121	Vlozka bocnice zadna	
B122		
B123		
B124	Uchyt bocnice	
B125	Bocnica podzostava	
B126	Prepazka izolacna	Prepazka izol
B127	Kryt prepazky	
B128	Lista krycia	
B129	Naraznik bocnice	
B130	Prepazka	



B131	Ochrana bocnice
B132	Drziak
C001	Behun ramu
C002	Lista
C003	Jokel spojovaci
C004	Kryt panela predny
C005	Matica
C006	Matica ramu
C007	Noha
C008	
C009	
C010	Noha ramu
C011	
C012	
C013	
C014	
C015	Predlzenie ramu
C016	
C017	
C018	Obluk ramu
C019	Panel nohy
C020	
C021	Podpera ramu
C022	
C023	Podpera sokla
C024	Profil ramu
C025	
C026	
C027	
C028	
C029	Profil spojovaci
C030	Ram
C031	
C032	
C033	
C034	
C035	
C036	
C037	
C038	Sokel nohy
C039	Tyc ramu pre kolieska
C040	Uholnik
C041	
C042	
C043	Vylozenie ramu
C044	
C045	Vystuha
C046	
C047	

C048		
C049		
C050	Zaslepka jokloviny	
C051	Podstavec	
C052	Stlpik na kolieska	
C053		
C054	Patka ramu	Patka
C055	Priecnik horny	
C056	Zaves	
D001	Doraz	
D002	Doska KCHJ	
D003	Drziak	
D004		
D005	Doska ventilov	
D006		
D007	Drziak kondenzatora	Drziak KND
D008		
D009		
D010	Drziak vanicky	
D011		
D012		
D013	Filterdehydrator	
D014	Hadica kondenzu	
D015		
D016		
D017		
D018		
D019		
D020	Kapilara	
D021	Kondenzacna jednotka	KCHJ
D022	Kondenzacna jednotka s uKND	uKCHJ
D023	Kondenzator	KND
D024	Kondenzator kompletny	KND s vent
D025	Kryt bocny	
D026		
D027		
D028		
D029	Kryt kondenzatora	Kryt KND
D030	Kryt vanicky	
D031		
D032	Miska	
D033	Miska kondenzu	
D034	Miska odparu	
D035	Miska s hadom	
D036	Podlozka	
D037	Podpera KCHJ	
D038	Podpera krytu vanicky	
D039		

D040	Prepazka kondenzatora	
D041		
D042	Prepazka odparovacej misky	
D043	Rebrik na odparovaciú spirálu	Rebrik na odp spirálu
D044	Rurka medena	Rurka-Cu
D045	Spirála odparovania	
D046	Spona vyhrevneho telesa	
D047	Ventilator	
D048	Vystuha vanicky	
D049	Uholnik pomocny	
D050	Izolacia	
D051	Drziak hornej vanicky	
D052		
D053	Kryt kondenzacnej jednotky	Kryt KCHJ
D054	Vystuha kondenzacnej jednotky	Vystuha KCHJ
D055	Ventil expanzny	Ventil EXP
D056	Vývod horný	
D057	Priruba	
D058	Kryt ventilatora	
E001	Bok tunela vyparnika	
E002	Doraz vyfukoveho plastu	
E003	Drziak celnej zarazky	
E004		
E005		
E006	Drziak plastu	
E007		
E008		
E009	Filter	
E010	Drziak ventilatora	
E011	Konzola rozdelovaca prudenia	Konzola rozdel prudenia
E012	Konzola sacej mriezky	
E013	Kryt plastu	
E014	Kryt tunela	
E015	Kryt tunela bocny	
E016	Kryt tunela predny	
E017	Kryt tunela sanie	
E018	Kryt tunela vyfuk	
E019	Kryt vane predny	
E020	Kryt ventilov	
E021	Kryt vyfuku	
E022	Kryt vyparnika	
E023		
E024		
E025		
E026		
E027		
E028		
E029	Kryt ventilatora	

E030	Krytka sania	
E031	Krytka vyfuku	
E032		
E033	Lista	
E034	Lista plastu	
E035	Mriezka sacia	
E036		
E037	Mriezka vyfukova	
E038		
E039	Mriezka vyparnika	
E040	Naraznik pre ofuk	Naraznik ofuk
E041	Nosic ventilatora	
E042	Nosic ventilatorov ofuku	
E043	Nosic vyfukovej mriezky	
E044	Ofuk skla	
E045	Nalepka krytu steny tunela	
E046	Panel stropu	
E047	Panel ventilatora	
E048	Panel zadny	
E049	Panel zadny dolny	
E050		
E051	Panel zadny horny	
E052	Panel zadny horny osvetlenie	
E053	Panel zadny osvetlenie	
E054	Plast vyfukovy	
E055	Podlozka vymedzovacia	
E056	Podpera naraznika ofuku	
E057	Podpera panela ventilatorov	
E058	Podpera zadneho panelu	
E059	Predlzenie krytu vyparnika	Predlzenie krytu
E060	Predlzenie panela ventilatorov	
E061	Prepazka vyparnika	
E062		
E063		
E064	Prepazka	
E065	Profil uchytenia plexiskla	
E066	Profil uchytenia zarazky	
E067	Rozdelovac prudenie	
E068	Stena tunela bocna	
E069	Stena tunela vnutorna	Stena tunela vnut
E070	Stena tunela vonkajsia	Stena tunela vonk
E071	Rozdelovac tunela	
E072	Teleso ofuku skla	
E073	Tesnenie tunela	
E074	Trojuholnik	
E075	Tunel prudenie vzduchu	Tunel prud vzduchu
E076	Uchyt plastu	
E077	Usmernovac prudenie	
E078	Vedenie	

E079		
E080		
E081	Ventilator	
E082	Vyparnik	
E083	Vystuha	
E084	Zarazka celna	
E085	Zaslepka ofuku skla	
E086	Zaves mriezky sacej	
E087	Zaves vyfukoveho plastu	Zaves vyfuk plastu
E088	Kryt usmernovaca	
E089	Usmernovac sania	Usmer sania
E090	Usmernovac vyfuku	Usmer vyfuku
E091	Mriezka ofuku	
E092	Celo sacej mriezky	
E093	Kryt panela ventilatorov	
E094	Izolacia	
E095	Panel vyfuku	
E096	Podpera vyfuku	
E097	Prepazka vnutorneho priestoru	Prepazka vnut priestoru
E098		
E099	Drziak	
E100	Zaslepka	
E101	Upchavka vyfuku	
E102	Kryt	
E103	Konzola police spodnej	
E104	Panel sania	
E105	Kryt steny tunela	
E106	Drziak vyparnika	
E107	Vantilator vyparnika	Ventilator vyp
E108	Podpera	
E109	Stena tunela	
E110	Kryt vyhrevneho telesa	
E111	Zaves	
E112	Prepazka kondenzatora	
E113	Konzola vyfuku	
E114	Bok vyfuku	
E115	Drziak vyfukoveho plastu	
E116	Konzola krytu vyparnika	
E117	Uchyt plastu vnutorny	
F001	Bok ramu	
F002	Bok vnutornej police	Bok vnut police
F003	Celo ramu	
F004	Celo police	
F005	Celo sklenenej police	Celo sklen police
F006	Dno vnutornej police	Dno vnut police
F007	Doraz police	
F008	Drziak cenovky	
F009	Drziak podpery police	Drziak podp police
F010	Drziak police	

F011	Dvere police	
F012	Gastro nadoby	GN
F013	Hranol prepojovaci	
F014	Dno police	
F015	Konzola osky	
F016	Konzola osvetlenia	
F017	Konzola police	
F018	Konzola police skladana	
F019	Konzola sklenenej police	Konzola sklen police
F020	Kryt kablov	
F021	Kryt police	
F022	Kryt ramu	
F023		
F024	Kryt skleneny	
F025	Lista cenovkova lepena	
F026	Lista cenovkova	
F027	Madlo police	
F028	Nosic police	
F029	Nosic police predny	
F030	Lista cenovkova dolna	
F031		
F032	Nosnik sklenenej police	Nosnik sklen police
F033	Plexisklo do police	
F034	Podpera police	
F035		
F036	Podpera stupnovitej police	
F037	Polica	
F038	Lexan do police	
F039		
F040	Polica na omrvinky	
F041	Bocnica police	
F042		
F043		
F044	Polica priehladna	Polica priehl
F045	Polica spodna	
F046	Polica spodna doplnkova	Polica spodna mala
F047		
F048		
F049	Polica vrchna	
F050		
F051		
F052	Polica stupnovita	
F053		
F054	Polyuretan	
F055	Prepazka	
F056		
F057	Ram sklenenej police	Ram sklen police
F058	Rost	
F059	Rost obly	
F060	Chrbat vnutornej police	

F061	Drziak	
F062	Spojka police	
F063	Polica vnutorna	
F064	Stena zadna	
F065	Tank police	
F066	Tesnenie dveri	
F067	Tyc cenovky	
F068	Vedenie cenovkovej listy	Vedenie cenov listy
F069	Vlozka dno	
F070	Vlozka police	
F071	Vystuha dvier	
F072	Vystuha police	
F073	Vystuha police skladana	
F074	Vystuha rostu	
F075	Vystuha sklenenej police	Vystuha sklen police
F076		
F077	Vystuha tanku	
F078	Vysuha spojky police	
F079	Zadna cast police	
F080	Zadna cast police skladana	
F081	Zarazka police	
F082	Vedenie kablov	
F083	Podpera tovaru	
F084	Podpera tovaru predna	
F085	Ram	
F086	Obruba police	
F087	Sokel vnutornej police	
F088	Vedenie vnutornej police	
F089		
F090		
F091		
F092	Rost pecivovy	
F093		
F094	Sablona	
F095	Kryt dvere police	
F096		
F097	Podlozka	
F098	Puzdro	
F099	Vlozka pracovnej dosky	Vlozka prac dosky
F100	Celo GN	
F101	Bok GN	
G001		
G002	Celo manipulacneho pultu	Celo MP
G003	Dekel dolny	
G004		
G005		
G006	Doraz celneho skla	
G007	Doraz celneho sokla	

G008	Doraz konektora	
G009	Doraz rolety	
G010	Doraz skla	
G011	Doraz skleneného krytu	
G012	Drziak bocného skla	
G013	Drziak celného sokla	
G014	Drziak cenovky	
G015	Drziak E profilu horný	
G016	Drziak horného panela	
G017	Drziak narazníka	
G018	Drziak ovládania	
G019	Drziak predného panela	
G020	Drziak dveri	
G021	Drziak reklamy	
G022	Drziak rolety	
G023	Drziak sacej mriežky	Drziak sac mriežky
G024	Drziak single dveri	
G025	Drziak teplomera	
G026	Drziak vedenia dveri	
G027	Drziak vyfukovej mriežky	Drziak vyfuk mriežky
G028	Drziak osvetlenia	
G029	Filter sokla	
G030	Galerka	
G031	Klin skla	
G032	Koleno narazníka	
G033		
G034	Roh	
G035	Koniec narazníkovej listy	Koniec naraz listy
G036	Konzola	
G037	Patka	
G038	Konzola dveri	
G039	Konzola galerky	
G040	Konzola horného profilu	
G041	Konzola krytu rur	
G042	Konzola osky	
G043	Konzola osky dolná	
G044	Konzola profilu	
G045	Konzola stĺpika	
G046	Kryt	
G047	Kryt bocného sokla	
G048	Kryt bocznej výstupy	
G049	Kryt boczny	
G050		
G051	Kryt celny	
G052		
G053	Kryt dolny	
G054	Kryt expanzného ventila	Kryt exp ventila
G055		
G056		
G057	Kryt horný	



G058	Kryt horny na posuvne dvere
G059	Kryt horny na single dvere
G060	Kryt horny predlzeny
G061	
G062	
G063	Kryt obvodovy
G064	
G065	
G066	Kryt predny
G067	Kryt predny vystuha
G068	Kryt prepazky vnutorny
G069	Kryt prepazky vonkajsi
G070	Kryt vyhrevneho telesa
G071	Kryt reklamny
G072	
G073	
G074	
G075	Kryt reklamy ochrana
G076	Kryt reklamy horny
G077	Kryt reklamy reflektor
G078	Kryt rolety
G079	Kryt rur
G080	Kryt rur bocny
G081	Kryt rur celny
G082	Kryt stlpika bocny
G083	Kryt stlpika vnutorny
G084	Kryt stredny
G085	Kryt tunela
G086	Kryt vane zadny
G087	Kryt vane predny
G088	Kryt vane spojovaci
G089	
G090	Kryt vnutorny
G091	
G092	Kryt vypinaca
G093	Kryt zadny
G094	
G095	Krytka horneho profilu
G096	Krytka naraznika
G097	Krytka nohy vnutorna
G098	Krytka nohy vonkajsia
G099	Lista dvojskla
G100	Lista krycia
G101	Lista na filter sokla
G102	Lista na reklamu
G103	Lista naraznikova
G104	Lista naraznikova bocna
G105	Lista spoja
G106	Matica stojiny
G107	Nadstavba

G108	Naraznik	
G109	Naraznik bocnice	
G110	Nosic	
G111	Noha horizontalna	Noha horizont
G112	Noha zvisla	
G113	Nosic konzoly	
G114	Nosic osvetlenia	
G115	Nosic police zadny	
G116	Nosic pravitka	
G117	Nosic prepazky	
G118		
G119	Nosic stola dolny	
G120	Mriezka	
G121	Ochrana hrany vodorovna	
G122	Ochrana hrany zvisla	
G123	Opora distancna	
G124	Oska pantu	
G125		
G126		
G127	Panel horny	
G128		
G129	Panel osvetlenia	
G130	Panel predny	
G131	Panel predny dolny	
G132	Panel predny galerka	
G133	Panel predny horny	
G134		
G135		
G136		
G137	Panel predny kolesovy	
G138		
G139	Panel predny napruzeny	
G140	Panel predny naraznik	
G141	Panel predny bez ofuk	
G142	Panel predny roh	
G143	Panel predny s ofukom	
G144	Panel predny sikmy	
G145	Panel zadny	
G146	Panel zadny roh	
G147	Pant	
G148	Pant sokla	
G149	Pant vnutorny	
G150	Pant vonkajsi	Pant vonk
G151	Patka naraznika	
G152	Patka nosica	
G153	Patka stojiny	
G154	Patka stojiny kladivo	
G155	Patka stojiny odliatok	
G156	Platna pantu	
G157	Plech bocny	

G158	Plech na ukotvenie	
G159	Nosic prachovky	
G160	Pliesok magnetu sokla	
G161	Pliesok s magnetom	
G162	Podlozenie dveri	
G163	Podlozka bocna	
G164	Podlozka dveri	
G165	Podlozka nosica osvetlenia	
G166	Podlozka pantu	
G167	Podlozka predneho krytu	
G168		
G169	Podlozka skla	
G170	Podlozka spojovacia	
G171		
G172	Podlozka vedenia naraznika	
G173	Podlozka zadneho stlpika	
G174	Podpera	
G175	Podpera police	
G176	Podpera predneho panela	Podpera pred panela
G177		
G178	Podpera preklapaca	
G179	Podpera sokla	
G180	Podpera skla	
G181	Podpera zadneho krytu	
G182	Polica manipulacneho pultu	Polica man pultu
G183	Prachovka	
G184	Pravitko	
G185	Prepazka	
G186	Prepazka deliaca	
G187		
G188	Prepazka linky	
G189	Prepazka medzi police	
G190	Prepazka izolacna	
G191		
G192	Prichytka	
G193	Prichytka bocnice	
G194	Prichytka skla	
G195	Prichytka skla zadna	
G196	Prichytka skleneného krytu	
G197	Prichytka prepazky	
G198	Profil celnej zarazky	Profil cel zarazky
G199	Profil E maly	
G200	Profil E velky	
G201	Profil horny	
G202	Profil	
G203		
G204		
G205	Profil osvetlenia	

G206	Profil skla	
G207	Profil topneho telesa	Profil top telesa
G208		
G209	Profil topneho telesa nizky	
G210		
G211	Profil V	
G212	Pruzina doraz	
G213	Pruzina skla	
G214	Ram dveri	
G215		
G216	Ram horny	
G217	Profil O	
G218	Profil Y6	
G219	Profil PF	
G221	Kryt reklamny predny	
G222	Kryt reklamny zadny	Kryt reklamny lista zad
G223	Sklo celne	
G224	Skrutka dveri	
G225	Skrutka vrub	
G226	Sokel bocny	
G227	Sokel bocny kolesovy	
G228	Sokel bocny motorovy	Sokel bocny motor
G229	Sokel bocny prachovkovy	
G230	Sokel celny	
G231	Sokel celny kolesovy	
G232		
G233	Sokel celny s ofukom	
G234	Sokel celny tropic	
G235		
G236	Sokel zadny	
G237	Sokel zadny motorovy	Sokel zadny motor
G238		
G239	Sokel zadny pre ovladanie	
G240	Sokel zadny s ofukom	
G241		
G242	Spojka vane	
G243	Spojka odpery preklapaca	
G244	Spojka profilu skla	
G245	Spojka rohu	
G246	Spojka	
G247	Stlpik zadny	
G248	Stojan vyparnika	Stojan vyp
G249	Stojina zadna	
G250	Stojina predna	
G251	Stojina sikma	
G252	Stojina vodorovna	
G253	Stojina zvisla	
G254	Svorkovnica ovladania	
G255	Rurka prednej stojiny	

G256	Tyc cenovky	
G257	Uholnik	
G258	Ukoncenie naraznika	
G259	Ukoncenie profilu	
G260	Vedenie bocneho skla	
G261	Vedenie dolnej cen listy	
G262	Vedenie naraznika	
G263	Valcek tlmica	
G264	Vedenie zadnych dveri	
G265	Vedenie dveri	
G266	Vedenie kabla	
G267	Vlozka	
G268	Vlozka celneho sokla	
G269	Vlozka panela	
G270	Vlozka panela predneho	
G271	Vlozka sokla	
G272	Vystuha	
G273	Vystuha celneho sokla	
G274	Vystuha dveri	
G275		
G276	Vystuha panela predneho	Vystuha panela pred
G277	Hranol	
G278	Vystuha profilu	
G279	Vystuha skleneného krytu	
G280	Vystuha krytu rolety	
G281	Vystuha sokla	
G282	Vystuha tanku	
G283	Vystuha krytu	
G283	Zaves rolety	
G284		
G285		
G286	Zaslepka	
G287	Zaves celneho panela	
G288	Zaves celneho sokla	
G289	Zaves prachovky	
G290	Zaves sokla sikmy	
G291	Zaves profilu dveri	
G292	Zaves zadneho sokla	
G293	Zrkadlo	
G294	Ochrana hran	
G295		
G296	Rychloskrutka	
G297		
G298		
G299	Podlozka	
G300		
G301	Krytka stojiny	
G302		

G303	Podložka stojiny
G304	
G305	Doraz
G306	Drziak profilu
G307	
G308	Kryt vanicky horny
G309	
G310	
G311	Podložka vedenia
G312	Podložka stlpika
G313	
G314	Konzola bocna
G315	Konzola zadna
G316	
G317	Nosic nadstavby
G318	
G319	Kryt panela
G320	
G321	
G322	Kryt plexi
G323	Nosic sokla
G324	Izolacia prac dosky
G325	Lista vodiaca
G326	Stojina vnutorna
G327	Nosic misky kondenzu
G328	Panel bocny
G329	Zaves zrkadla
G330	Polyuretan
G331	Stojina nizka
G332	Vedenie panela predneho
G333	
G334	Rebro
G335	Zaves sokla
G336	Drziak
G337	
G338	Krytka ramu
G339	Lista vedenia
G340	
G341	Trubka
G342	Stena tunela
G343	Drziak krytu rolety
G344	Kanalizacia
G345	Drziak zrkadiel
G346	Doraz obkladu
H001	Bok ziarica infra
H002	Deflektor ziarica infra
H003	Doraz krytu UL
H004	Drziak objimok

H005	Drziak objimky halogena	
H006	Drziak osvetlenia	
H007	Drziak startera	
H008	Konzola LED profilu	
H009	Krabica halogena	
H010	Krabica s tlmivkami	
H011	Kryt	
H012	Kryt drziaka objimok	
H013	Kryt LED profilu	
H014	Kryt osvetlenia	
H015	Kryt startera	
H016	Kryt vodcov	
H017	Kryt ziarica infra	
H018	Lista upevnenia	
H019	Nosic	
H020	Nosic infra	
H021	Nosic objimok halogena	
H022	Nosic osvetlenia	
H023	Nosnik predradnika	
H024	Osvetlenie	
H025	Osvetlenie bocnice	
H026	Osvetlenie zvisle	
H027	Osvetlenie police	Osvet police
H028	Lampa	
H029	Lampa police	
H030	Panel dvojiteho osvetlenia	
H031	Panel osvetlenia	
H032	Osvetlenie sokla	
H033	Panel osvetlenia police	
H034	Pasik LED	
H035	Plech tlmiviek	
H036	Podpera panela osvetlenia	Podpera panela osvet
H037	Podpera reklamy	
H038	Prichytka LED profilu	
H039	Profil LED	
H040	Profil osvetlenia	
H041	Spojka osvetlenia	
H042	Spona odlahcovacia	
H043	Svietidlo	
H044	Teleso osvetlenia police	Teleso osvet police
H045	Teleso ziarica infra	
H046	Vystuha osvetlenia	
H047	Zaslepka LED profilu	
H048	Zaves panelu osvetlenia	
H049	Zemnenie	
H050	Ziaric halogenovy	
H051	Ziarivka s krytom	
H052	Ziaric infra	
H053		
H054		

H055	Plech predradnika	
H056	Vedenie kabla	
H057	Spona hadice	
H058	Poistka	
H059		
H060		
H061		
H062	Podpera osvetlenia	
H063		
H064		
H065	Nosic ziarica	
H066		
H067		
H068	Reflektor	
I001	Lista DIN	
I002	Drziak panela ovladania	
I003	Drziak vypinaca	
I004	Krabica displeja	
I005	Kryt ovladania	
I006	Krytka dolna	
I007	Krytka horna	
I008	Lista vedenia	
I009	Maska panela ovladania	Maska panela ovlad
I010	Nosic kablov	
I011	Nosic ovladania	
I012	Ovladanie	
I013	Panel displeja	
I014	Panel elektro	
I015	Panel ovladania	
I016	Panel ovladania drziak	
I017	Panel ovladania krabica	
I018	Vystuha ovladania	
I019	Uchyt ovladania	
I020	Vedenie panelu ovladania	Vedenie panelu ovlad
I021	Drziak prepinaca	
I022	Podlozka izolacna	Podlozka izol
I023	Kryt svorkovnice	
I024	Spinac osvetlania	
I025	Podpera ovladania	
I026	Nosic ventilov	
I027	Oneskorovac	
I028	Regulator	
J001	Hranol pracovnej dosky	Hranol prac dosky
J002	Kryt pracovnej dosky	Kryt prac dosky
J003	Obal pracovnej dosky	Obal prac dosky
J004	Plech pracovnej dosky	Plech prac dosky
J005	Podlozka stojiny	
J006	Polyuretan	PUR prac dosky



J007	Pracovna doska	Prac doska
J008	Vystuha pracovnej dosky	Vystuha prac dosky
J009	Ukoncenie pracovnej dosky	Ukoncenie prac dosky
J010	Podpera	
J011	Nosic pracovnej dosky	Nosic prac dosky
K001	Cap	
K002	Brzda dveri	
K003	Dvere	
K004	Dvere kridlove	
K005	Dvere posuvne	
K006	Doraz dveri	
K007	Dvere supacie	
K008	Kryt dveri	
K009	Kryt ramu	
K010	Nosic dveri	
K011	Drziak	
K012		
K013	Lista dveri	
K014	Lista vedenia	
K015		
K016	Lista skla dolna	
K017		
K018	Madlo dveri	
K019	MDF bocnice plech dolny	
K020	MDF bocnice plech horny	
K021	Osvetlenie	
K022	Paleta	
K023	Pant dveri	
K024	Pant vane	
K025	Plast dveri	
K026		
K027	Platna	
K028	Podlozka	
K029	Podpera	
K030		
K031		
K032		
K033		
K034	Polyuretan dvere	
K035	Profil	
K036	Profil adapter pozdlzny	
K037	Profil adapter priecny	
K038	Profil horny	
K039	Profil pozdlzny	
K040	Profil ramu bocny	
K041	Profil ramu horny	
K042	Profil vertikálny	
K043	Ram bocny vnutorny	Ram bocny vnut
K044	Ram bocny vonkajsi	Ram bocny vonk

K045	Ram dveri	
K046	Ram horny vnutorny	Ram horny vnut
K047	Ram horny vonkajsi	Ram horny vonk
K048	Ram posuvnych dveri	
K049	Ram stredny	
K050		
K051		
K052	Sklo dveri	
K053		
K054	Spojka rozna	
K055	Tesnenia dolne	Tesnenia dol
K056	Tesnenia horne	Tesnenia hor
K057	Tesnenie	
K058	Tesnenie dveri	
K059		
K060	Vedenie tesnenia horizontalne	
K061	Vedenie tesnenia vertikalne	
K062	Vlozka ramu bocna	
K063		
K064	Vlozka ramu horna	
K065	Vypln rohu ramu dvierok	
K066	Vystuha	
K067	Vystuha dveri pozdlzna	
K068	Vystuha dveri priecna	
K069	Zaves dveri	
K070	Zeslepka celna	
K071	Kolik pantu	
K072	Puzdro pantu	
K073	Ochrana hrany	
K074	Vedenie dveri	
K075	Profil kridlovych dveri	
K076	Profil posuvnych dveri	
K077	Kryt nocny	
K078		
K079	Spojka dveri	
K080	Drziak profilu	
K081	Konzola	
K082	Profil E nizky	
K083	Profil E vysoky	
L001	Vlozka profilu	
L002	Vlozka formy	
L003	Kopyto	
L004	Kopyto na kryt dvier	
L005	Bocnica surova	
M001	Balenie	

M002	Bok	
M003	Bok roletovy	
M004	Cap	
M005	Cap skla	
M006	Cap tlmica	
M007		
M008	Dosedka police stola	
M009	Dosedka police vane	
M010	Doska	
M011	Doska stola	
M012	Drziak	
M013	Drziak cenovky	
M014	Drziak cidla	
M015	Drziak harkoveho papiera	Drziak harok papier
M016	Drziak lyziny	
M017	Drziak plexiskla	Drziak plexi
M018	Drziak poistky cidla	
M019	Drziak poistneho cidla	Drziak poist cidla
M020	Drziak reklamy	
M021	Drziak rolety	
M022	Drziak sokla	
M023	Drziak solenoidu	
M024	Drziak ventilov	
M025	Galerka	
M026	Gastronadoby	
M027	Hak	
M028		
M029	Hmotnost obsluzky	
M030	Hranol dreveny	
M031	Chrbat regala	
M032	Kanal	
M033	Kanal horny	
M034	Kanalizacia	
M035	Klucka	
M036	Kolik krycej listy	Kolik listy krycej
M037	Kolik spojovaci	
M038	Spinac hladiny dolnej	
M039	Spinac hladiny hornej	
M040	Konzola	
M041		
M042	Konzola na zaves hakov	
M043	Konzola police	
M044	Konzola pracovnej dosky	
M045	Konzola vitriny	
M046	Kryt	
M047	Kryt rolety	
M048	Kryt stojana	
M049		
M050		
M051	Kryt vanicky	

M052	Kryt zadny	
M053	Krytka	
M054	Krytka podpery skla	
M055		
M056		
M057		
M058	Lyzina	
M059	Lyzina drevena	
M060	Lyzina ocelova	
M061	Lyzina ocelova na kolieska	Lyzina ocelova kol
M062	Matica plexi spoja	
M063	Matica skla	
M064		
M065		
M066	Nadrz	
M067	Nadstavba	
M068	Noha	
M069	Noha stola	
M070	Nosic E profilu horny	
M071	Nosic hladinoveho spinaca	Nosic hladin spinaca
M072	Nosic kanalizacie	
M073	Nosic pohyblivej prepazky	
M074	Nosic tlmicov	
M075	Nosic trubiek galerky dlhy	
M076	Nosic trubiek galerky kratky	
M077	Nosic zasuvky pokladne	
M078	Nosnik gulovych ventilov	Nosnik gul ventilov
M079	Obal dosky pod narezovy stroj	Obal dosky pod narez stroj
M080	Obal dosky pod vahu	
M081	Obrys ostrova	
M082	Oska pantu	
M083	Oska preklapaca	
M084	Oska preklapaca duo	
M085	Oska preklapaca solo	
M086	Oska preklapaca stredna	Oska preklapaca stred
M087	Oska pantu stredneho	Oska pantu stred
M088	Oska tlmica	
M089	Oska tlmica predna	
M090	Oska tlmica zadna	
M091	Oska tlmica zadna stredna	
M092	Skrutka ozdobna	
M093		
M094	Patka naraznika	
M095	Patka nohy	
M096	Patka prepazky	
M097	Patka stola	
M098	Patka trubky	
M099	Patka vane	

M100	Patka zamku	
M101		
M102		
M103		
M104		
M105		
M106		
M107		
M108	Podesta stojana	
M109	Podlozka	
M110	Podlozka krytky osvetlenia	Podlozka krytky osv
M111	Podlozka trubky police	
M112	Podlozka trubky vane	
M113	Podlozka vymedzovacia	
M114	Podpera police	
M115	Podpera skla	
M116	Podpera sokla	
M117	Polica regala	
M118	Polystyren	
M119		
M120	Posuvne dvere	
M121	Predna stojina	
M122	Polyuretan	PUR
M123	Preklapac	
M124	Prepazka dolna	
M125	Prepazka medzipolicova	Prepazka medzipol
M126		
M127	Prepazka nanukova pozdlzna	Prepazka nanukova pozdlz
M128	Prepazka nanukova priečna	
M129	Prepazka nizka	
M130	Prepazka nizka pohybliva	
M131	Prepazka pod policu	
M132	Prepazka pohybliva	
M133	Prepazka	
M134	Prepazka vysoka	
M135	Prepazka vysoka pohybliva	
M136	Prepazky nanukove	
M137	Prichytka skla	
M138	Prichytka skleneného krytu	Prichytka krytu sklenen
M139	Prichytka trubky dolna	
M140	Prichytka trubky horna	
M141	Pripravok na nastavenie bocnice	Pripravok na nast bocnice
M142	Priprava	
M143	Profil E dolny	
M144	Profil E horny	
M145	Profil horny	
M146		
M147	Profil posuvnych dvierok	
M148	Profil rohu	
M149	Podlozka pod cidlo	

M150	Profil stojana prepazok	
M151	Profily posuvnych dvierok	Profily posuv dvierok
M152	Pruzina gulicka	
M153	Puzdro cidla	
M154	Puzdro preklapaca	
M155	Ram nohy	
M156	Ram nohy pevny	
M157	Ram pevneho stolika	
M158	Ram stolika	
M159	Regal	
M160	Kryt reklamny	
M161	Roh regala	
M162	Roleta	
M163	Rozperka naraznika	
M164	Rurka Cu	
M165	Sablona	
M166	Skrutka plexi spoja	
M167	Skrutkovy spoj plexiskla	
M168	Sokel	
M169	Sokel regala	
M170	Spojka lyziny	
M171	Spojka	
M172	Spojka skla	
M173	Stojan na sacky	
M174	Stojan na tasky	
M175	Stojan vyparnika	
M176		
M177	Stojina stojana	
M178	Stojina zadna	
M179	Stred regala	
M180	Strieska	
M181	Strieska krajna	
M182	Trubka police kanalova	
M183	Trubka vane	
M184	Trubka vodorovna	
M185	Trubka zvisla	
M186	Podlozka tovaru tvarova	
M187	Trubka galerky	
M188	Tyc regala	
M189	Tyc spojovacia	
M190	Uholnik	
M191		
M192	Valcek naraznika bocnice	
M193	Valcek naraznika cela	
M194	Valcek tlmica	
M195	Vedenie hranola	
M196	Vesiak stojana	
M197	Vlozka	

M198	Vrch regala	
M199		
M200	Trubka	
M201	Vystuha naraznika cela	
M202	Zamok dverovy	
M203	Zamok pantovy	
M204	Zamok prepojovaci	Zamok prepoj
M205		
M206	Zaslepka sokla na ostrov	
M207	Zaves hakov	
M208		
M209		
M210		
M211	Paleta	
M212	Vypodlozenie	
M213	Priruba	
M214	Rost celo	
M215	Poistka skla	
M216	Vystuha	
M217	Prepazka zadna	
M218	Nosic police	
M219	Spoj naraznika	
M220	Koliesko Torwege 2xD50	
M221	Rozdelovac	
M222	Trubka vymedzovacia	
M223		
M224	Konzola panela	
M225	Rozperka	
M226	Nosnik spojovaci	
M228	Celo zasuvky	
M229	Priecnik	
M230		
M231	Stojina	
M232	Nosnik nadstavby	
M233	Doraz	
M234	Vanicka	
M235	Skrutka	
M236	Kryt horny	
M237	Kryt vnutorny	
M238	Podpera krytu	
M239	Patka stojiny	
M240	Zarazka zamku	
M241	Stolik	
M242	Prichytka kabla	
M243	Podpera	
M244	Patka	
M245	Prepinac	
M246	Prychitka vyhrev tyce	
M247	Spojka rovna	
M248	Rost	

M249	Madlo
M250	
M251	Dno zasuvky
M252	
M253	Vedenie rolety
M254	Doraz rolety
M255	
M256	Nosic teplomera
M257	Krabica
M258	Podpera panela
M259	Tesnenie skla
M260	
M261	Prepazka cela
M262	Doska zvlhcovacej jednotky
M263	Drziak ZVJ
M264	Podpera prac dosky
M265	Drziak horneho profilu
M266	Kos
M267	
M268	Drziak misky kondenzu
M269	Ram
M270	Trubka zvlhcovania
M271	Distributor zvlhcovania
M272	
M273	Drziak distributora
M274	
M275	
M276	Rebro distributora
M277	Bok nadstavby
M278	Dvojplatna
M279	Koniec zasuvky
M280	
M281	Polica
M282	Zavitova tyc
M283	Zatka
M284	Generator pary
M285	Kryt zasuvky
M286	Nosic
M287	Prichytka police
M288	Kryt bocny
M289	Zaves
M290	Kryt dolny
M291	Naraznik
M292	Profil skla
M293	Zasuvka
M294	Sifon
M295	Zvlhcovacia jednotka
M296	Zamok
M297	Konzola galerky
M298	



M299

Obklad

## **Názov výkresu GB**

Accumulator - liquid

Side - condenser

Side - vaporiser

Filter dehydrator

Elbow

Compressor

Condenser

Accumulator - refrigerant

Electronics box - compressor

Cover - condenser

Cover - fan

Segment - condenser

Segment - vaporiser

Magnet - valve

Grid - fan

Ring - fan

Hub

Tube/pipe condenser

Tube/pipe - vaporiser

Solenoid

Spiral - condensate evaporating

T piece

Valve

Valve, expansion

Valve, ball

Valve, supply

Fan

Propeller

Evaporator

Adapter to expansion valve

Nozzle to expansion valve

Motor, Engine

Probe

Glue

Lock inline

Display

Halogen

Circuit breaker

Cable, supply

Cable, heating

Cables

Clips

Probe

Wheel - thermostat

Condenser, anti-interference  
(humming)  
Connector  
Interface  
End - tube cover  
Signal light, green  
Electric box

Cover, LED  
Cover - fluorescent tube  
Cover - fluorescent tube, T5  
Strip, DIN  
Sleeve  
Sleeve, DZ  
Sleeve - halogen  
Sleeve with starter  
Sleeve - tube

Grounding piece  
Control

Holder  
Strip, LED  
Ballast

Reducing sleeve  
Switch disconnecting  
Clamp

Profile, LED  
Controler  
Relay

Switch coupler  
Switch, level  
Switch, float  
Starter  
Contactor  
Lighting unit

Grounding terminal  
Terminal box

Element, heating

Thermometer, mechanical  
Thermometer, solar  
Thermometer, block-type  
Thermometer, control-type  
Choke coil  
Bar, heating tray  
Bar, heating  
Valve, expansion  
Switch  
Master switch  
End cap, LED  
Plug

Socket  
Heater, infra-red  
Fluorescent tube

Button

Sleeves with connectors  
Switch, magnetic

Pump  
Filter - UV  
Ultrasonic humidifier

Door  
Double glass - sidewall  
Double glass, front  
Double glass, upper  
Cover, glass  
Cover, glass, duo  
Cover, glass, solo  
Strip - double glass  
Panel  
Shelf, glass  
Divider, high, fixed  
Frame, isolation  
Serigraphy  
Glass - sidewall  
Glass, front  
Glass, front, duo

Glass, front - end  
Glass, front, solo  
Glass, front - middle  
Triple glass - sidewall  
Triple glass - front  
Deflector  
Front riser  
Mirror  
Mirror - sidewall  
Glass, double glass  
Glass, rear  
Glass  
Double glass  
Cover  
Glass coupler

Pin - door hinge  
Condenser  
Holder - condensate hose  
Holder - handle  
Holder - bumper  
Holder - night blind  
GN pan  
Fruit box  
Stop block - glass  
Holder  
Adapter

Button  
Rubber reducing sleeve  
Fastener/dowel  
Pump  
Sewer  
Elbow

Wheel  
Wheel with brake

Bearing  
Sliding fittings

Basket  
Cover - switch  
Cover - thread bar  
Cover plate, corner  
Magnet - rick plate  
Nut - carrier, level switch  
Grommet nut

Evaporator tray

Carrier - level switch

Carrier - tube/pipe

Foot adjustable

Hinge - door

Draw band

Footing, self-adhesive

Footing - tube/pipe

Stand - internal stand

Ruler

Grommet

Presostat

Clamp/clip - glass

Flange - water hose

Flange - drain

Casing - hinge

Controller - condens. pressure

Reduction

Spring

Bumper/corner

Night blind

Lockable shutter

Tube

Spacing tube

Siphon pipe  
Connecting piece

Drain connection

Connecting piece - pipes/tubes

Thermometer, acrylic glass  
Piston

Piston, glass

Tube/pipe

Bar, thread  
Valve  
Stopper

End cap - mirror clamp

Screw/bolt

Nut

Hose, metal-plated  
Hose, high-pressure  
Elbow with internal and external  
threads  
Insert piece, adjusting  
Rivet  
Insert piece, hexagonal, reduced

Stop block - shelf  
Nut - exp. valve  
Backplate - Torwegge

Belt

Hose socket, reduced

Flange, hose

Clamp/clip - cable

Strip, price tag

Suction pad

Bollhoff sleeve

Suspension - blind

Lock

Fast Profile

Connecting piece corner

Handle

Silent Block

Screw

Tube/pipe, spacer

Cover

Price holder

Casing - damper

Leg

Clip



Ending, overflow  
Nut - Ending

Screw  
Nut  
Backplate  
Split pin  
Rivet  
Pin  
Stainless Steel Circlips  
Chipboard Screw  
Nut - Rivet  
Insert piece  
Bar - threaded

Prism

Palette, foot  
Palette  
Packing, sidewall  
Packing, front face  
Packing, top  
Crate

Sign - height goods  
Label - high-lift truck  
Carton corner piece  
Protection - edge  
Polystyrene

Side, internal  
Side, external

Stop block - hinged

Holder - evaporator, tray

Holder - work top  
Holder - exhaust grid  
Hose - electric installations  
Timber, MDF  
Cover - infra-red heater  
Cover, detector hole  
Cover - body

Cover - tray  
Cover, front - tray  
Cover - radiant heater

Segment - trayf

Strip, longitudinal - door

Strip, transversal - door

Strip, buffer

Strip - set door

Seat - heating cord

Carrier - acrylic glass

Carrier, front - shelf

Carrier, rear - shelf

Carrier - exhaust grid

Protection, upper - edge

Protection, vertical - edge

Strip

Backplate

Support

Support, lower

Support, upper

Support - shelf

Support - ceiling

Support - exhaust grid

Support - rear panel

Polystyrene

Polyurethane

Extension

Divider

Divider - body

Profile - glass

Frame

Frame - wood reinforcement

Reinforcement connector

Brace - stiffener

Stiffener - reinforcement

Bottom, wood

Bottom - bath

Bottom, internal

Bottom, external

Joining piece - body

Wall, front

Wall, internal

Wall, external

Wall, rear

Wall, rear internal

Wall, rear external

Rear stand

Centre point, double-sided

Centre point - body

Centre point, internal

Centre point, external

Angle piece, interconnecting

Seal, longitudinal

Body

Insert piece, lower

Insert piece, upper

Insert piece - bath

Insert piece, internal

Insert piece, external

Top - body

Top, internal

Top, external

Stiffener

Stiffener, lower

Stiffener, upper

Stiffener, anchoring

Stiffener, front

Stiffener, middle/central

Stiffener - body

Stiffener, rear

Catcher, dirt

Cover - profile

Insulation

Panel - reducing sleeve

Cond - tray

Cover - wood stiffener

Drip, tray

Tray

Cover - Stiffener

Footing - Stiffener, middle / central

Sidewall

Sidewall, DTD  
Sidewall, upper  
Sidewall, bottom

Sidewall, insulation  
Sidewall, MDF  
Sidewall, solid

Sidewall - panoramic  
Sidewall - bottom

Sidewall, mirror  
Divider , double-sided  
Double glass  
Stop block - sidewall glass  
Holder - sidewall glass holder  
Hose, electric installations -  
sidewall  
Kapaline - sidewall  
Cover - sidewall  
Cover, lower - sidewall  
Cover, upper - sidewall  
Cover, front upper - sidewall  
Cover, rear upper - sidewall  
Cover with bend - sidewall  
Cover, internal - sidewall  
Cover, external - sidewall  
Cover, rear - sidewall  
Cover - insulation sidewall  
  
Cover, internal - insulation sidewall  
  
Cover, external - insulation  
sidewall  
  
Cover - high insulation sidewall  
  
Cover - sidewall lamp  
Edge cover  
Cover, internal - sidewall  
corner/edge  
Cover, external - sidewall  
corner/edge  
  
Strip, front - sidewall  
Strip, front, UK - sidewall  
Strip, cover - sidewall  
Strip, cover, UK - sidewall  
Strip, bumperr - sidewall

Strip, circumferential - sidewall

Strip, internal - sidewall

Strip, cover - divider

Strip, cover - insulation sidewall

Strip - sidewall lighting

Strip, - sidewall glass

Strip - sidewall glass mounting

Outline - sidewall

Cast piece - sidewall corner

Protection - sidewall kick plate

Protection - sidewall bottom

Panel - sidewall

Panel, cover - sidewall

Sheet - sidewall

Sheet, internal - sidewall

Sheet, external - sidewall

Sheet - sidewall embedding

Support - sidewall kick plate

Support

Polyurethane - sidewall

Clamp - sidewall moulded part

Profile - sidewall glass

Shelf stand - sidewall

Corner - sidewall

Glass - sidewall

Kick plate - sidewall

Bottom - sidewall

Bottom, internal - sidewall

Bottom, external - sidewall

Wall - sidewall

Wall, external - sidewall

Wall, internal - sidewall

Centre point - sidewall

Centre point, external - sidewall

Centre point, internal - sidewall

Screen - sidewall

Bar - sidewall

Angle piece - sidewall mounting

Clamp - sidewall glass

Guide - sidewall

Guide - bomper, sidewall

Guide - sidewall glass

Insert piece - sidewall

Insert piece, whisking - sidewall

Top - sidewall

Pressed piece - sidewall

Pressed piece, internal - sidewall

Pressed piece, external - sidewall

Filling - moulded part, sidewall

Reinforcement - sidewall

Reinforcement, anchoring -  
sidewall

Reinforcement, polystyrene -  
sidewall

Reinforcement -sidewall lighting

Reinforcement - sidewall  
corner/edge

Reinforcement

Side wall, Q

Strip, lower - insert piece

Strip, upper - insert piece

Strip, rear - insert piece

Sheet - sidewall insert piece

Kapaline - sidewall insert piece

HPS - sidewall insert piece

Insulation - sidewall

Insert piece, rear - sidewall

Grip - sidewall

Sidewall, subassembly

Divider - insulation

Cover - divider

Strip, cover

Bumper, sidewall

Protection, sidewall  
Holder

Sliding piece - frame  
Strip  
Connecting piece (prism)  
Cover, front - panel  
Nut  
Nut - frame  
Leg

Leg - frame

Extension - frame

Arc - frame  
Panel - leg

Support - frame

Support - kick plate  
Profile - profile

Profile, interconnecting  
Frame

Kick plate, leg  
Bar - frame, wheel  
Angle piece, long

Lining - frame

Reinforcement



End cap - profile (prism)  
Stand  
Supporting member - wheel

Flap, frame  
Crossbar, upper  
Hinge

Stop block - kick plate  
Plate - condensing unit  
Plate, counteracting - condensing  
unit

Plate - valves

Holder - condenser

Holder - tray

Filter-dehydrator  
Hose - condenser

Capillary tube  
Condensing unit  
Condensing unit with uKND  
Condenser  
Condenser, complete  
Cover, side

Cover - condenser  
Cover - bath

Tray - condenser  
Tray - evap.  
Tray - (evap) tray with piping  
Pad  
Support - condensing unit  
Support - tray cover

Divider - condenser

Evap.tray divider

Ladder for evap.tray

Tube, Cu

Evaporation spiral

Clamp - heating unit

Fan

Tray reinforcement

Angle piece, auxiliary

Insulation

Holder, upper tray

Cover - condenser, unit

Reinforcement - condensing unit

Valve - expansion

Terminal, upper

Flange

Fan cover

Side - evaporator

Stop block - exhaust plastic

Holder - front good stopper

Holder - plastic

Filter

Holder - fan

Bracket - flow distributor

Bracket - suction grid

Cover - plastic

Cover - tunnel

Cover, sideboard - tunnel

Cover, front - tunnel

Cover - tunnel, suction

Cover - tunnel, exhaust

Cover, front - body

Cover - valves

Cover - exhaust

Cover - evaporator

Cover - fan

Cover plate - suction  
Cover plate - exhaust

Strip - plastic  
Grid, suction

Grid, exhaust

Grid - evaporator  
Bumper for antimisting  
Carrier - fan  
Carrier - antimisting fans  
Carrier - exhaust grid  
Antimisting - glass  
Panel, upper - front part  
Panel - ceiling  
Panel - fans  
Panel, rear  
Panel, lower

Panel, rear, upper  
Panel, rear, upper - lighting  
Panel, rear - lighting  
Panel, exhaust  
Spacer

Support - for antimisting bumper

Support - fan panel  
Support - rear panel  
Extension - evaporator cover  
Extension - fan panel  
Divider - evaporator

Divider - exhaust grid  
Profile - acrylic glass mounting  
Profile - divider mounting  
Flow distributor  
Wall, side - tunnel  
Wall, internal - tunnel  
Wall, external - tunnel  
Tunnel divider  
Unit - exhaust grid  
Gasket - tunnel  
Triangle  
Tunnel - air flow  
Clamp - plastic  
Deflector

Fan  
Evaporator  
Reinforcement  
Front riser  
Antimisting  
Suspension - suction grid  
Suspension - exhaust plastic  
Cover - baffle  
Intake rectifier  
Exhaust rectifier  
Blower grid  
Front face - suction grid  
Cover - fan panel  
Insulation  
Panel - exhaust  
Support - exhaust  
Divider - internal space

Holder  
End cap  
Seal - blower  
Cover  
Bracket -shelf, lower  
Panel - intake  
Cover - wall, tunel  
Holder - evaporator  
Evaporator fan  
Support  
Wall - tunel  
Cover - heating body  
Hinge

Side - frame  
Side - internal shelf  
Front face - frame  
Front face - shelf  
Front face - glass shelf  
Bottom - internal shelf  
Stop block - shelf  
Holder - price  
Holder - shelf support  
Holder - shelf

Door - shelf  
GN pans

Bracket - axis  
Bracket - lighting  
Bracket - shelf  
Bracket - folded  
Bracket - glass shelf  
Cover - cables  
Cover - shelf  
Cover - frame

Cover, glass  
Price holder - Self adhesive  
Price holder  
Handle - shelf  
Carrier - shelf  
Carrier, front - shelf  
Price holder bottom

Beam - glass shelf  
Shelf, PMMA  
Support - shelf

Support - stepped shelf  
Shelf  
Shelf, fish

Crumb shelf  
Shelf, side

Shelf, transparent  
Lower shelf  
Lower shelf additional

Shelf, upper

Shelf, stepped

Polyurethane  
Divider

Frame - glass shelf  
Grill  
Grill, rounded  
Internal shelf back

Holder

Connecting piece - shelf

Shelf, internal

Rear - wall

Tank - shelf

Gasket - door

Bar - price holder

Guide - price holder

Insert piece - bottom

Insert piece - shelf

Reinforcement - door

Reinforcement - shelf

Reinforcement, folded - shelf

Reinforcement - grid

Reinforcement - glass shelf

Reinforcement - tank

Reinforcement - shelf connecting  
piece

Rear part - shelf

Rear part, folded - shelf

Riser - shelf

Guide - cables

Support - goods

Support, front - goods

Frame - GN

Trim - shelf

Kick plate - shelf, internal

Guide - shelf, internal

Template

Cover - door shelves

Pad

Case

Insert

Front face - GN

Side - GN

Front face - neutral table

Cover plate, lower

Stop block - front glass

Stop block - front kick plate

Stop block - coupler  
Stop block - night blind  
Stop block - glass  
Stop block - glass cover  
Holder - side glass  
Holder - front kick plate  
Holder - price  
Holder, upper - E profile  
Holder - upper panel  
Holder - bumper  
Holder - control  
Holder - front  
Holder - door frame  
Holder - banner  
Holder - night blind  
Holder - suction grid  
Holder - single door  
Holder - thermometer  
Holder - door guide  
Holder - exhaust grid  
Holder - lighting  
Filter - kick plate  
Bag holder  
Wedge - glass  
Elbow - bumper

Corner - bumper  
End - bumper  
Bracket

Bracket - door  
Bracket - bag holder  
Bracket - top profile  
Bracket - pipe/tube cover  
Bracket - centre line  
Bracket, lower - centre line  
Bracket - profile  
Bracket - stand  
Cover  
Cover - side kick plate  
Cover - reinforcement  
Cover, side

Cover, front

Cover, lower  
Cover - expansion valve

Cover, upper

Cover, upper - sliding door  
Cover, upper - single door  
Cover, upper - extended

Cover, circumferential

Front cover

Cover, front - reinforcement  
Cover, internal - divider  
Cover, external - divider  
Cover, heater  
Cover, advertising

Cover - banner, protection  
Cover - banner, upper sheet  
Cover - night blind  
Cover - shutter  
Cover - tubes  
Cover, side - tubes  
Cover, front - tubes  
Cover, side - stand  
Cover, internal - stand  
Cover, middle  
Cover - tunnel  
Cover, rear - body  
Cover, front - body  
Cover, interconnecting - body

Cover, internal

Cover - switch  
Cover, rear

Cover plate - upper profile  
Cover plate - bumper  
Cover plate, internal - leg  
Cover plate, external - leg  
Strip - double glass  
Kick plate  
Strip - filter  
Strip - banner  
Strip, bumper  
Strip, side, bumper  
Strip - connecting piece  
Nut - stand  
Extension



Bumper  
Side wall bumper

Leg, horizontal  
Leg, vertical  
Carrier - bracket  
Carrier - lighting  
Carrier, rear - shelf  
Carrier - ruler  
Carrier - divider

Carrier, lower - table  
Grid  
Protection, horizontal - edge  
Protection, vertical - edge  
Support, spacing

Panel, upper  
Panel, rear, upper  
Panel, lighting  
Front panel  
Front panel, lower  
Front panel - bag holder  
Front panel, upper

Front panel, wheel

Front panel, spring-loaded  
Front panel - bumper  
Front panel - island  
Front panel edge/corner  
Front panel with blower  
Front panel, bevelled  
Rear panel  
Rear panel corner  
Hinge  
Hinge - kick plate  
Hinge, internal  
Hinge, external  
Footing - buffer  
Footing - carrier  
Footing - stand  
Footing - web plate, hammer  
Footing - web plate, cast piece  
Plate - hinge  
Sheet, side

Sheet for anchorage

Carrier - duster

Leaf - kick plate

Leaf with magnet

Backing - door

Backplate, side

Backplate - door

Backplate - lighting carrier

Backplate - hinge

Backplate - front cover

Backplate - glass

Backplate, interconnecting

Backplate - bumper guide

Backplate - supporting element,  
rear

Support

Support - shelf

Support - front panel

Support - tipper

Support - kick plate

Support - glass

Support - rear cover

Shelf - neutral table

Duster

Ruler

Divider

Divider, separating

Divider - line

Divider - shelving

Divider - insulation

Clamp/clip - supporting element  
side cover

Clamp/clip - sidewall

Clamp/clip - glass

Clamp/clip, rear

Clamp/clip - glass cover

Clamp/clip - divider

Profile - front riser

Profile E, small

Profile E, large

Profile, upper

Profile

Profile - lighting

Profile - glass  
Profile - heater

Profile - heater, short

Profile V  
Spring - stop block  
Spring - glass  
Frame - door

Frame, upper  
Profile, O  
Profile, Y6  
Profile, PF  
Banner cover, front  
Banner cover - flood light  
Glass, front  
Screw/bolt - door  
Screw/bolt - notch  
Kick plate, side  
Kick plate, side, plug-in  
Kick plate, side, duster  
Kick plate, front  
Kick plate, front  
Kick plate, wheel, front

Kick plate, front andimisting  
Kick plate, front tropic

Kick plate, reinforcement  
Kick plate, rear, plug-in

Kick plate, rear - control  
Kick plate, rear, antimisting

Joining piece - body  
Joining piece - tilt support  
Joining piece - glass profile  
Joining piece - corner  
Joining piece  
Rear stand

Supporting member, Evaporator

Stand, rear  
Stand, front  
Stand, bevelled  
Stand, horizontal  
Stand, vertical

Front stand tube

Price holder bar  
Angle piece  
Bumper end  
Profile, end  
Side glass guide  
Lower price holder  
Guide - bumper  
Piston roller  
Guide - rear door  
Guide - door  
Guide - cable  
Insert piece  
Insert piece - kick plate, front  
Insert piece - panel  
Insert piece - panel, front  
Insert piece - kick plate  
Stiffener  
Front kick plate reinforcement  
Reinforcement, door

Reinforcement - front panel  
Prism  
Reinforcement - profile  
Reinforcement - glass cover  
Reinforcement, night blind cover  
Reinforcement - kick plate  
Reinforcement - tank  
Reinforcement - cover  
Night blind hinge

End cap  
Suspension - front panel  
Suspension - front kick plate  
Suspension - duster  
Suspension, bevelled - kick plate  
Suspension - door profile  
Suspension - rear kick plate  
Mirror  
Protection - edges

Quick-release screw/bolt

Backplate

Cover plate - stand

Backplate - stand

Stop block

Holder - profile

Cover, upper - body

Backplate - guide

Backplate - supporting element

Bracket, side

Bracket, rear

Carrier - extension

Cover - panel

Cover - plexi

Carrier - kick plate

Insulation - work top

Strip, guide

Stand, inside

Carrier - drip tray

Panel, sideways

Suspension - Mirror

Polyurethane

Low stand

Guide - panel, front

Suspension - kick plate

Holder

Cover - Frame

Strip - guide

Tube

Wall - tunnel

Holder - cover, blind

Drain

Side - infra-red heater

Deflector - infra-red heater

Stop block - UL cover

Holder - sleeves

Holder - halogen sleeves  
Holder - lighting  
Carrier  
Bracket - LED section  
Halogen box  
Box with choke coils  
Cover  
Cover - sleeve holder  
Cover - LED section  
Cover - lighting  
Cover - starter  
Cover - conductors  
Cover - infra-red heater  
Strip - mounting  
Carrier  
Carrier, infra-red  
Carrier - halogen sleeves  
Carrier - lighting  
Beam - ballast  
Lighting  
Lighting - sideboard  
Lighting - vertical  
Lighting - shelf  
Lamp  
Lamp shelf  
Panel - double lighting  
Panel - lighting  
Lighting, kick plate  
Panel, - shelf lighting  
Strip, LED  
Sheet - choke coils  
Support - lighting panel  
Support - banner  
Clamp/clip - LED profile  
Profile, LED  
Profile - lighting  
Connecting piece - lighting  
Clip, balancing  
Lighting unit  
Body/unit - shelf lighting  
Body/unit - infra-red heater  
Reinforcement - lighting  
End cap - LED section  
Suspension - lighting panel  
Grounding  
Halogen heater  
Fluorescent tube with cover  
Heater, infra-red

Sheet - ballast  
Guide - cable  
Clip - hose  
Fuse

Support - lighting

Carrier, radiator

Spotlight

Strip, DIN  
Holder - control panel  
Holder - switch  
Box - display  
Cover - control panel  
Cover, lower  
Cover - upper  
Strip - guide  
Control panel mask  
Carrier - cables  
Carrier - control  
Control  
Panel - display  
Panel - electric installations  
Panel - control  
Panel, control - holder  
Panel, control - box  
Stiffener - control  
Clamp/clip - control  
Guide - control panel  
Switch holder  
Insulating pad  
Terminal block cover  
Lighting switch  
Controller support  
Carrier - valve  
Run delay  
Regulator

Prism - work top  
Cover - work top  
Protection - work top  
Sheet - work top  
Backplate - stand  
Polyurethane

Work top  
Stiffener - reinforcement  
End - work top  
Support  
Carrier - work top

Pin - door hinge  
Brake - door  
Door  
Door, hinged  
Door, sliding

Door, sliding, island  
Cover - door  
Cover - frame  
Carrier - door

Strip - door  
Strip - guide

Strip, lower - glass

Handle - door  
MDF sidewall - sheet, lower  
MDF sidewall - sheet, upper  
Lighting  
Palette  
Hinge - door  
Hinge - body  
Plastic - door

Plate  
Backplate

Polyurethane - door  
Profile  
Profile - adapter, longitudinal  
Profile - adapter, transversal  
Profile, upper  
Profile, longitudinal  
Profile, side - frame  
Profile, upper - frame  
Profile, vertical  
Frame, side, internal  
Frame, side, external



Frame - door  
Frame, upper, internal  
Frame, upper, external  
Frame - sliding door  
Frame, medium-size

Glass - door

Connecting piece, different types

Gaskets, lower  
Gaskets, upper  
Gasket  
Gasket - door

Guide, horizontal - gasket  
Guide, vertical - gasket  
Insert piece, side

Frame Insert piece, upper  
Filling - door frame corner  
Reinforcement

Reinforcement, longitudinal - door

Reinforcement, transversal - door

Suspension - door  
End cap, front  
Pin - hinge  
Casing - hinge  
Protection - edge  
Guide - door  
Section - swing door  
Section - sliding door  
Cover - overnight

Connecting piece - door  
Holder - Profile  
Bracket  
Profile E small  
Profile E big

Profile insert  
Mold insert

Hoof - cover, door  
Side wall raw

Side

Side, night blind

Pin

Pin - glass

Pin - damper

Contact piece - table

Contact piece - body shelf

Plate

Plate - table

Holder

Holder - price

Holder - detectors

Holder - paper sheets

Holder - skid

Holder - acrylic glass

Holder - detector fuse

Holder - safety detector

Holder - banner

Holder - night blind

Holder - kick plate

Holder - solenoid

Holder - valves

Bag holder

Gastro trays

Hook

Weight, serve over cabinet

Beam, wood

Back, shelf stand

Channel

Channel, upper

Drain

Handle

Pin - cover strip

Pin, interconnecting

Switch, lower - level

Switch, upper - level

Bracket

Bracket - hook suspension

Bracket - shelf

Bracket - work top

Bracket - display case

Cover

Cover - night blind

Cover - stand

Cover - body

Cover, rear  
Cover plate  
Cover plate - glass support

Skid  
Skid, wood  
Skid, steel  
Skid, steel (for wheels)  
Nut - acrylic joining piece  
Nut - glass

Tank  
Extension  
Leg  
Leg - table  
Carrier, upper - E section  
Carrier - level switch  
Carrier - drain  
Carrier - movable divider  
Carrier - dampers  
Carrier, long - bag holder  
Carrier, short - bag holder  
Carrier - cash register drawer  
Beam - ball valves  
Protection - plate under slicing  
machine  
Protection - plate under scale  
Outline - island  
Centre line - hinge  
Centre line - tipper  
Centre line - tipper, duo  
Centre line - tipper, solo  
Centre line, middle - tipper  
Centre line - middle hinge  
Centre line - damper  
Centre line, front - damper  
Centre line, rear - damper  
  
Centre line, middle, rear - damper  
  
Screw/bolt decorative

Footing - buffer  
Footing - leg  
Footing - divider  
Footing - table  
Footing - tube  
Footing - body

Footing - lock

Platform - stand

Backplate

Backplate - lighting cover plate

Backplate - shelf tube/pipe

Backplate - body tube/pipe

Spacer

Support - shelf

Support - glass

Support - kick plate

Shelf - shelf stand

Polystyrene

Sliding door

Stand, front

Polyurethane

Tipper

Dividerl, lower

Divider, between shelves

Divider, longitudinal, ice-lolly

Divider, transversal, ice-lolly

Divider, short

Divider, movable

Divider, under shelf

Divider, mobile

Divider, high

Divider, high, movable

Divider, ice - lolly

Clamp/clip - glass

Clamp/clip - glass cover

Partition wall, glass cover

Clamp/clip, lower - tube/pipe

Clamp/clip, upper - tube/pipe

Adjusting element - sidewall

Section E, lower

Section E, upper

Section, upper

Section - sliding door

Section - corner

Section, glass

Profile - stand, divider

Profiles - sliding door

Spring - ball

Casing - detector

Casing - tipper

Frame - leg

Frame, fixed - leg

Frame - fixed table

Frame - table

Shelf stand

Banner cover

Corner - shelf stand

Night blind

Brace - buffer

Tube, Cu

Template

Screw/bolt - acrylic joining piece

Screw joint - acrylic glass

Kick plate

Kick plate - shelf stand

Connecting piece - skid

Connecting piece, different types

Connecting piece - glass

Stand - plastic bags

Stand - bags

Stand - evaporator

Web plate - stand

Web plate, rear

Centre point - shelf stand

Roof

Roof, end

Tube/pipe, drainage - shelf

Tube/pipe - body

Tube/pipe, horizontal

Tube/pipe, transversal

Formed backplate under goods

Bar - bag holder

Bar - shelf stand

Bar, interconnecting

Angle piece

Roll - sidewall bumper

Roll - front face bumper

Roll - damper

Guide - beam

Hanger - stand

Insert piece

Top - shelf stand

Tube/pipe, spacer

Reinforcement - front bumper

Lock, door

Lock, hinge

Lock, interconnecting

End cap - kick plate, island

Suspension hook

Palette

Backing

Flange

Front grid

Safety lock - glass

Stiffener

Dividerl, rear

Shelf holder

Connecting piece - bumper

Wheel, Torwege 2xD50

Distributor

Tube - limiting

Bracket - panel

Brace

Beam, connecting

Front face - drawer

Stand

Superstructure holder

Stopper

Body

Screw

Cover, top

Cover, internal

Stand bracket

Stand foot

Stop lock

Table

Clamp - cable

Support

Foot

Switch

Heater holder

Connecting piece - equal

Grid

Drawer - bottom

Night blind guide  
Night blind stopper

Carrier - thermometer  
Box  
Support - Panel  
Gasket - glass

Dividerl, front face  
Plate - Humidifier unit  
Holder ZVJ  
Support - work top  
Holder - top, section  
Basket

Holder - drip tray  
Frame  
Tube -/pipe - humidification  
Distributor, humidification

Holder - distributor

Ladder, distributor  
Side , extension  
Double plate  
Ending - Socket

Shelf

Generator - steam  
Cover  
Carrier  
Clamp - Shelf  
Cover - side  
Hinge  
Cover, lower  
Bumper  
Profile - glass  
Socket  
Siphon  
Humidifier unit

Bracket - bag holder

Facing