

EXPLOSIONSZEICHNUNG

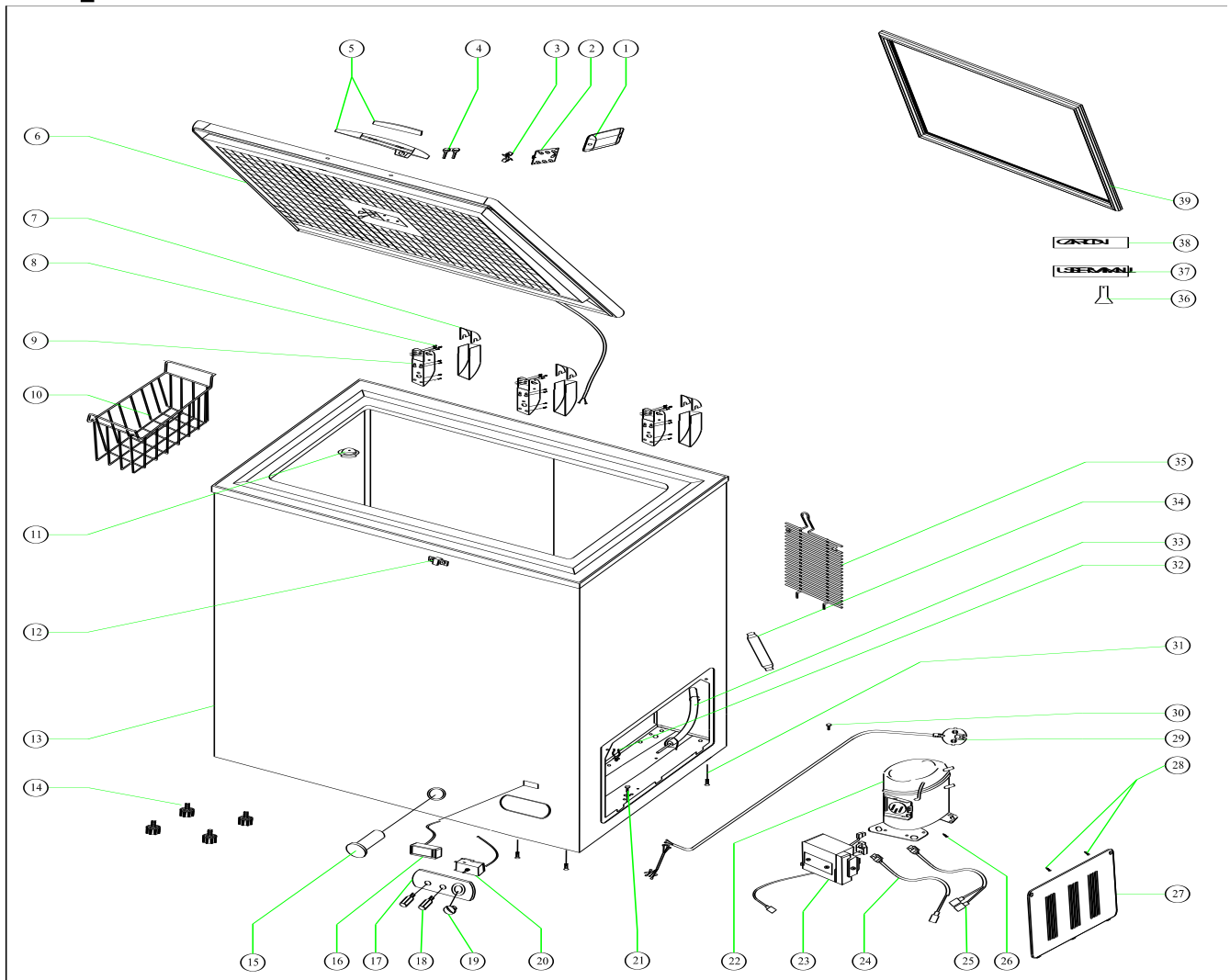

KBS Gastrotechnik GmbH – Schoßbergstraße 26 – 65201 Wiesbaden

Exploded View



Parts List of KBS 57 CNS

No.	Parts Code	Parts Name	QTY.
1	102010513	Lampshade	1
2	106020118	LED light	1
3	102010227	separation column	3
4	101090014	key	2
5	102010118	Handle with lock	1
6	61405500093	Door	1
7	102010174	Hinge Cover	3
8	105020034	Screw	22
9	101060041	Hinge	3
10	101070010	Basket	4
11	102010155	Drain stopper	1
12	101090080	latch hook	1
13	60205500097	Box shell.	1
14	101090032	Adjustable feet	4

15	102010146	Drain plug	1
16	106030014	thermograph	1
17	106020010	indicator light	2
18	102010039	Thermostat knob	1
19	102010011	Control panel	1
20	106030187	Thermostat	1
21	105020012	Screw	3
22	106040369	Compressor (including accesso	1
23	106040369-1	Controller	1
24	106010865	Controller signal line	1
25	106010936	Controller Power line	1
26	106040797-2	Screw	1
27	60601050001	Grille	1
28	105020077	Screw	3
29	106010645	Power cord	1
30	105020001	Screw	1
31	105020023	Screw	6
32	102010179	Snap Bushing	1
33	105010013	Insulation pipe	1
34	101080042	Filter drier	1
35	101070257	Back grill	1
36	102010128	Defrost shovel	1
37	104020843	Use manual	1
38	104013196	Carton	1
39	102020016	Seal	1