

EXPLOSIONSZEICHNUNG

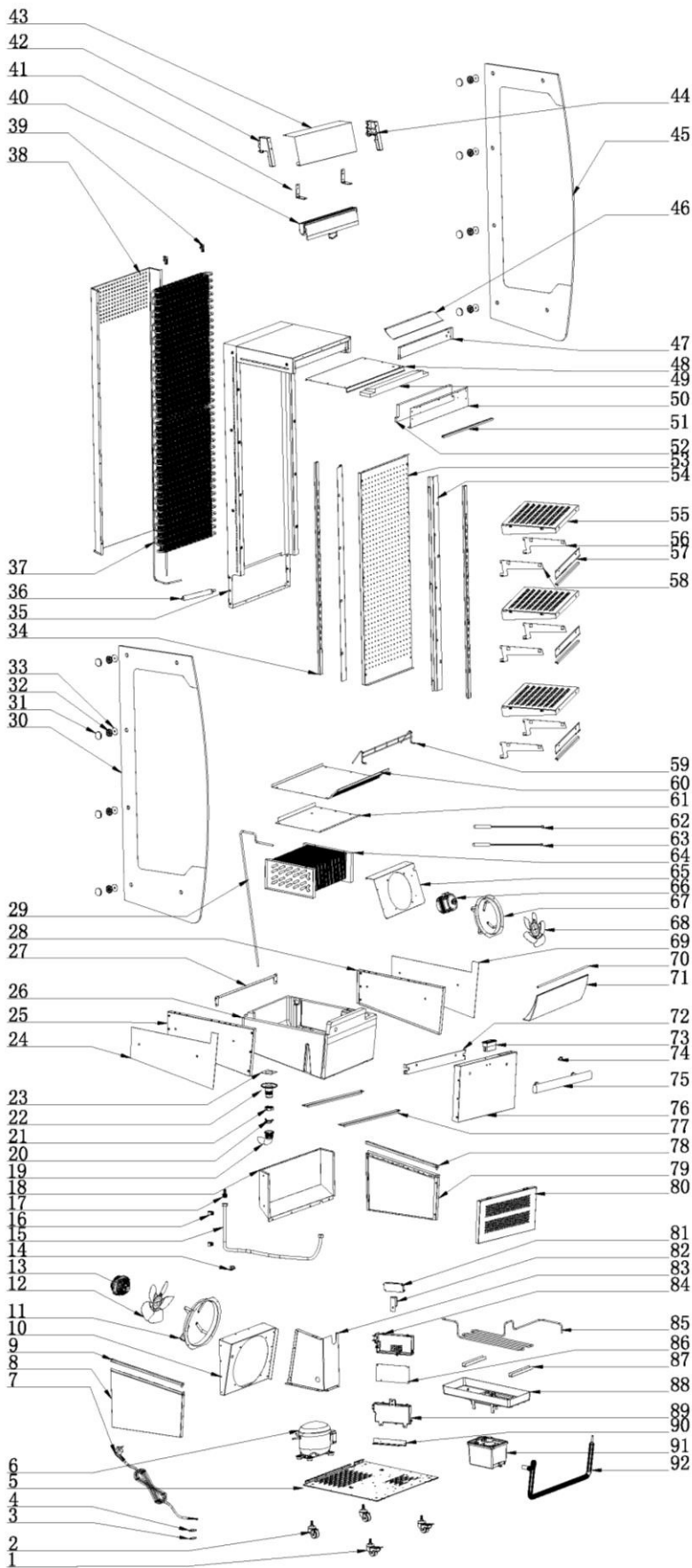

KBS Gastrotechnik GmbH – Schoßbergstraße 26 – 65201 Wiesbaden



92	2.5.0.13.046	Glass water pipe
91	3.3.001	Water receiver
90	24.3.01.049	Control box bracket
89	2.5.0.06.008	Circuit board box
88	2.5.0.12.006	Water box
87	2.4.3.01.064	Pressing plate of high pressure pipe
86	2.3.03.080	Main circuit board
85	2.2.3.385	High press copper pipe
84	2.5.0.06.007	Cover for circuit board box
83	2.4.3.01.083	Thermostat baffle
82	2.4.5.30.006	Power switch cover
81	2.3.07.008	LED transformer
80	24.3.01.065	Front bottom base panel
79	24.3.01.036	Right stainless steel panel of base
78	2.5.3.01.002	Right plastic gutter
77	2.4.3.01.062	Bottom board of cooling room
76	2.4.3.01.031	Front bottom base panel
75	2.4.0.13.009	Knob
74	2.5.0.09.035	Night curtain hook
73	2.3.04.031	Temperature Display
72	2.4.3.01.048	Handle stiffener
71	2.5.3.01.005	Wind deflector
70	3.5.3.01.001	Strip of wind deflector
69	2.7.03.1008	PE of right panel
68	2.3.02.311	Fan blade
67	2.3.02.410	Flange
66	2.3.02.002	Fan Motor for evaporator
65	3.4.3.01.061	Motor Bracket
64	2.2.1.024	Evaporator
63	2.3.03.841	Compressor protect probe
62	2.3.03.803	Temperature probe
61	3.4.3.01.058	Evaporator cover board
60	2.4.3.01.030	Bottom board of cabinet
59	2.4.3.01.053	Wire protector
58	3.4.0.15.003	Left support pillar of shelf
57	2.4.3.01.029	Label board
56	3.4.0.15.004	Right support pillar of shelf
55	2.4.3.01.060A	shelf
54	2.4.3.01.068	Threading board
53	2.4.3.01.067	Ventilated board
52	2.7.03.1004	Insulating foam
51	2.3.05.2.052	Top LED light
50	2.4.3.01.069	Curtain fix board
49	2.5.0.21.014	Honeycomb board
48	2.4.3.01.066	Ceiling board of cabinet
47	2.4.3.01.072	PE cotton baffle
46	2.4.3.01.075	Pressure wind board
45	2.6.1.03.072	Right glass
44	2.5.3.01.014	Right holder for curtain
43	2.4.3.01.033	Front panel on the top
42	2.5.3.01.013	Left holder for curtain
41	3.4.3.01.056	Transparent night curtain bracket
40	2.5.0.09.009	Transparent night curtain
39	2.5.3.06.008	Condensator bracket
38	2.4.3.01.052	Back condensator cover
37	2.2.2.085	Condensator
36	2.2.6.006	Dry filter
35	3.1.2.010	Foam of back cover
34	2.4.0.02.054.008	Pole for shelf
33	2.5.0.17.009	Decoration Nut Gasket
32	2.5.0.17.010	Nut Gasket
31	2.4.0.16.001	Nut Decoration
30	2.6.1.03.071	Left glass
29	2.2.3.085	Connecting pipe
28	2.4.3.01.070	Right board of cooling room
27	2.4.3.01.081	Crossbeam of base
26	2.7.02.0105	Evaporator holder
25	2.4.3.01.071	Left board of cooling room
24	2.7.03.1007	PE of left panel
23	3.4.3.09.079	Downpipe pressure board
22	2.5.3.09.008	Pipe joint
21	2.5.1.10.044	Nut
20	2.4.0.12.203	Circlip
19	2.5.0.13.001	Water pipe
18	2.4.3.01.051	Base rear cover
17	2.4.0.09.215	Copper connection
16	2.5.0.18.003	PPR tube strap
15	2.4.0.09.003	Stainless steel drainage
14	2.4.0.12.305	Pressing plate of dry filter
13	2.3.02.004	Fan Motor for evaporator
12	2.3.02.304	Fan blade
11	2.3.02.407	Flange
10	2.4.3.01.082	Condensator bracket
9	2.5.3.01.001	Right gutter
8	2.4.3.01.037	Left stainless steel panel of base
7	2.3.01.048	Power cord
6	2.1.006	Compressor
5	2.4.3.01.050	Base Board
4	2.5.0.06.015	Wire clip cover
3	2.5.0.06.016	Wire clip holder
2	2.4.0.08.006	Wheels without brake
1	2.4.0.08.008	Wheels with brake
No.		Parts Name